

STANTOBANAT

Profile margine / Profiles

Accessories

Profile WE 40x40 · 7.5

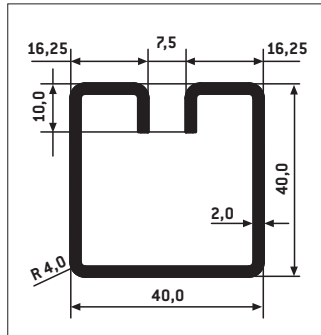

Material	Material thickness in mm	Slot width in mm	Item number	Weight kg/m
Steel	2.00	7.5	100681	2.39

Accessories

Profile WE 40x40 · 9.6

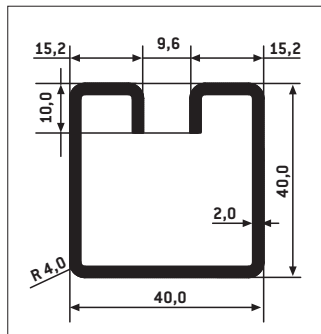

Material	Material thickness in mm	Slot width in mm	Item number	Weight kg/m
Steel	2.00	9.6	100682	2.36

Accessories

Profile GEV 30x30 · 3.0

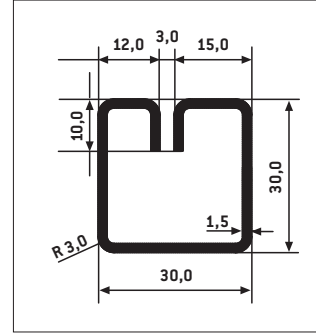

Material	Material thickness in mm	Slot width in mm	Item number	Weight kg/m
Steel	1.50	3.0	100689	1.46
Stainless steel				
X5CrNi18-10 2B	1.4301 IIIC	1.50	100692	1.46

Accessories

Profile GEV 30x30 · 4.0

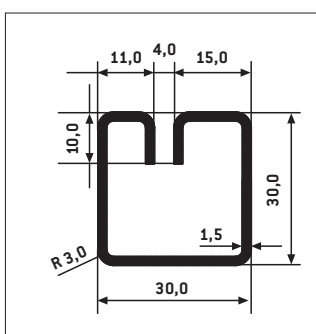

Material	Material thickness in mm	Slot width in mm	Item number	Weight kg/m
Steel	1.50	4.0	100690	1.46
Pre-galvanised				
DX51D	St 02 Z	1.50	101243	1.46
Stainless steel				
X5CrNi18-10 2B	1.4301 IIIC	1.50	100693	1.46

Accessories

U-Profile · 1.8

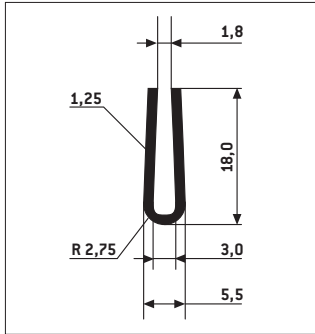

Material		Material thickness in mm	Slot width in mm	Item number	Weight kg/m
Pre-galvanised					
DX51D	St 02 Z	1.25	1.8	100697	0.36
Aluminium					
EN AW-1050A H24	Al 99,5% hh	1.25	1.8	101186	0.12
Stainless steel					
X5CrNi18-10 2B	1.4301 IIIC	1.25	1.8	100700	0.36

Accessories

Profile WE 30x30 · 5.7

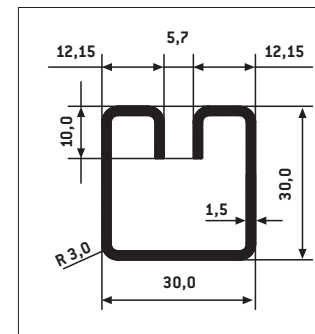

Material		Material thickness in mm	Slot width in mm	Item number	Weight kg/m
Steel					
		1.50	5.7	100679	1.43
Pre-galvanised					
DX51D	St 02 Z	1.50	5.7	100684	1.43
Stainless steel					
X5CrNi18-10 2B	1.4301 IIIC	1.50	5.7	101240	1.43

Accessories

Profile SE 15.2x25 · 3.1-7.3

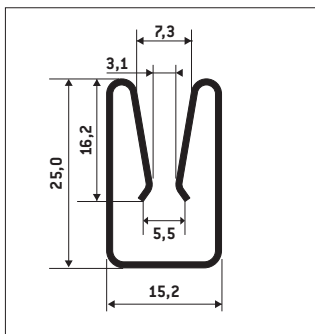

Material		Material thickness in mm	Slot width in mm	Item number	Weight kg/m
Steel					
		0.80	3.1-7.3	101305	0.59

Accessories

Profile WE 30x30 · 7.5

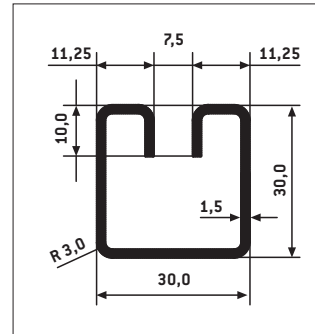

Material		Material thickness in mm	Slot width in mm	Item number	Weight kg/m
Steel					
		1.50	7.5	100680	1.40
Pre-galvanised					
DX51D	St 02 Z	1.50	7.5	100685	1.40
Stainless steel					
X5CrNi18-10 2B	1.4301 IIIC	1.50	7.5	100688	1.40

Accessories

Profile LE 20x30 · 1.7

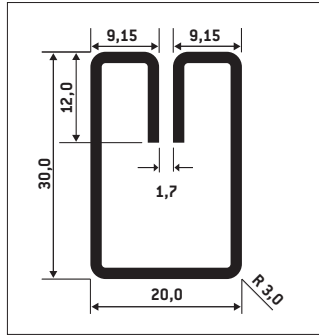

Material		Material thickness in mm	Slot width in mm	Item number	Weight kg/m
Steel					
		1.50	1.7	100656	1.27
Pre-galvanised					
DX51D	St 02 Z	1.50	1.7	100663	1.27
Aluminium					
EN AW-1050A H24	Al 99,5% hh	1.50	1.7	100673	0.44
Stainless steel					
X5CrNi18-10 2B	1.4301 IIIC	1.50	1.7	100668	1.27
// polished grain 320		1.50	1.7	100677	1.27

Accessories

Profile LT 20x20 · 1.7

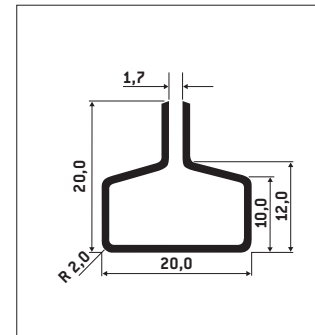

Material		Material thickness in mm	Slot width in mm	Item number	Weight kg/m
Steel					
		1.25	1.7	100653	0.67
Pre-galvanised					
DX51D	St 02 Z	1.25	1.7	100660	0.67

Accessories

Profile LE 20x30 · 2.7

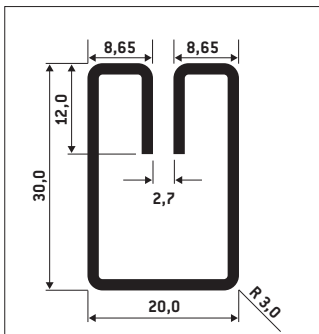

Material		Material thickness in mm	Slot width in mm	Item number	Weight kg/m
Steel					
		1.50	2.7	100659	1.27

Accessories

U-Profile · 1.3

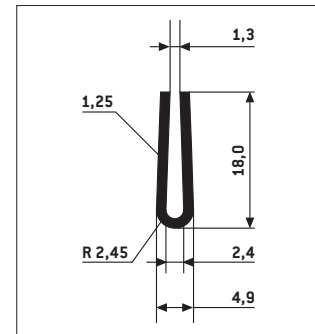

Material		Material thickness in mm	Slot width in mm	Item number	Weight kg/m
Pre-galvanised					
DX51D	St 02 Z	1.25	1.3	100696	0.36
Stainless steel					
X5CrNi18-10 2B	1.4301 IIIC	1.25	1.3	100699	0.36

Accessories

Profile LR 27 · 1.8

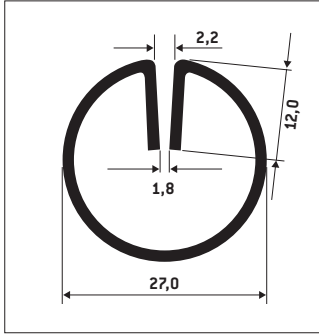

Material		Material thickness in mm	Slot width in mm	Item number	Weight kg/m
Steel					
		1.50	1.8	100655	1.12
Pre-galvanised					
DX51D		1.50	1.8	100662	1.12
Aluminium					
EN AW-1050A H24	Al 99,5% hh	1.50	1.8	100672	0.39
Stainless steel					
X5CrNi18-10 2B	1.4301 IIIC	1.50	1.8	100667	1.12
// polished grain 320		1.50	1.8	100676	1.12

Accessories

Profile LE 12x18 · 1.3

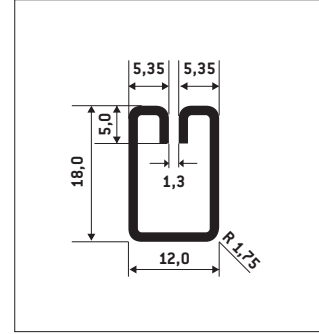

Material		Material thickness in mm	Slot width in mm	Item number	Weight kg/m
Steel					
		1.25	1.3	101367	0.55
Pre-galvanised					
DX51D		1.25	1.3	101368	0.55
Stainless steel					
X5CrNi18-10 2B	1.4301 IIIC	1.25	1.3	100772	0.55
// polished grain 320		1.25	1.3	100943	0.55

Accessories

Profile LR 27 · 2.7

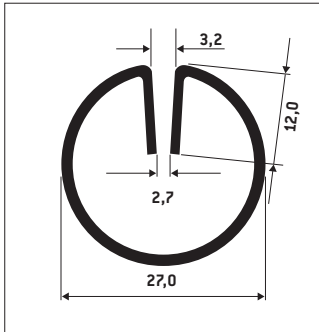

Material		Material thickness in mm	Slot width in mm	Item number	Weight kg/m
Steel					
		1.50	2.7	100658	1.12

Accessories

Profile LE 12x18 · 1.8

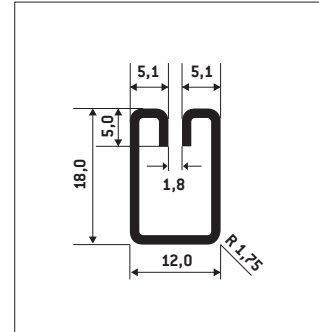

Material		Material thickness in mm	Slot width in mm	Item number	Weight kg/m
Steel					
		1.25	1.8	100771	0.56
Aluminium					
EN AW-1050A H24	Al 99,5% hh	1.25	1.8	101183	0.19

Accessories

Profile LR 10 · 1.3

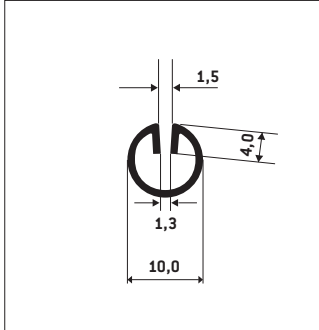

Material		Material thickness in mm	Slot width in mm	Item number	Weight kg/m
Steel					
		1.00	1.3	100766	0.24
Stainless steel					
X5CrNi18-10 2B	1.4301 IIIC	1.00	1.3	100768	0.24
// polished grain 320		1.00	1.3	100944	0.24

Accessories

Profile LR 18 · 1.7

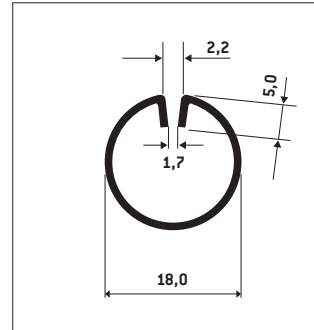

Material		Material thickness in mm	Slot width in mm	Item number	Weight kg/m
Steel					
		1.25	1.7	100654	0.57
Pre-galvanised					
DX51D		1.25	1.7	100661	0.57
Aluminium					
EN AW-1050A H24	Al 99,5% hh	1.25	1.7	100671	0.20
Stainless steel					
X5CrNi18-10 2B	1.4301 IIIC	1.25	1.7	100666	0.57
// polished grain 320		1.25	1.7	100675	0.57

Accessories

Profile LR 18 · 1.3

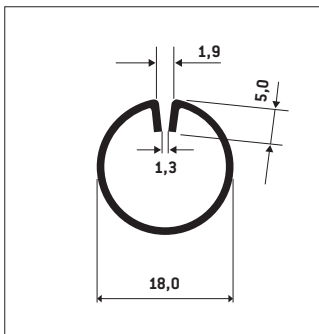

Material		Material thickness in mm	Slot width in mm	Item number	Weight kg/m
Stainless steel					
X5CrNi18-10 2B	1.4301 IIIC	1.25	1.3	101492	0.57
// polished grain 320		1.25	1.3	101493	0.57

Accessories

Profile LR 27 · 1.3

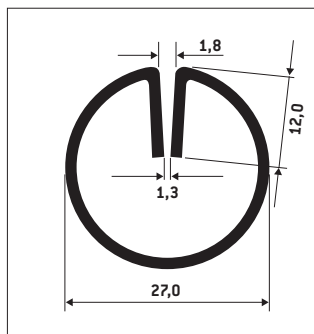

Material		Material thickness in mm	Slot width in mm	Item number	Weight kg/m
Stainless steel					
X5CrNi18-10 2B		1.50	1.3	101495	1.12
// polished grain 320		1.50	1.3	101495	1.12